

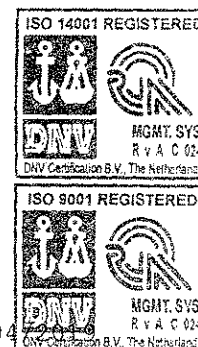

Punjab Alkalies & Chemicals Limited

Regd. Office : S.C.O. 125-127, Sector 17-B, Chandigarh - 160 017 (INDIA)
 Phone : 0172-4072508-568, E- mail : info@punjabalkalies.com Fax : 0172-2704797
 CIN : L24119CH1975PLC003607, Website : www.punjabalkalies.com



RFQ Master Enquiry

Ref No PACL/ENQ/1/kkg/PL-RFQ-00051

Date 18/04
 Unit ALL

Dear Sir,

Kindly Send us your most competitive offers so as to reach us on or before 26-APR-19 for the supply of the under mentioned items :

S. Item Code / No Description Of Material	Quantity Unit	
1 PL-039-50014 <u>INTERLOCKING PANEL</u>	1.000 NO	<p>COMPLETE PREWIRED CONTROL PANEL WITH ALL INSTRUMENTS AND EQUIPMENTS FOR INSTRUMENTS AIR DRYER IN U-1 (Dimensional drawing enclosed)</p> <p>1:Self standing control panel on 50 mm IAS angle base with height of 400 mm & grounding studs at both (LHS & RHS) lower ends.</p> <p>2:Panel structure should be treated for sand blasting, percolated in nine tank chemical process heated in baking oven and finally finished with two coats of powder coating each of 80-100 micron of approved shades as follows a)Outer: Siemens grey (RAL70231) b)Inner: brilliant white c)Instruments mounting base plate: tractor orange(RAL 2000)</p> <p>3:Control panel sides, doors, back and base structure should be made of CRCA sheet of thickness 2.0 mm, 3.0 thick CRCA sheet for instrument mounting base plates(both upper and lower compartments) and 3.0 thick CRCA sheet for removable gland plate at panel top with pre drill holes for glands as per drawing.</p> <p>Door panel should be flushed style with heavy duty self lubricated external hinges of SS materials at LHS, panel door handles at RHS of SS material and door locks should also be of good quality in SS materials, same nos. of door lockes and hinges should additionally be supplied as spare.</p> <p>Internal neoprene gasket on all four sides of doors to avoid dust and gas, panel protection IP54.</p>

Instruments tag plates should be in SS with tag name punching on it and riveted accordingly below instruments on front door and back side of door as well..

Enlosed:

1: Detailed dimensional drawing of control panel .

2: Bill of material.

RFQ Master Enquiry

Terms & Conditions :

Note: Please send your offer in two separate envelopes having priced & technical bid before due date. Material is required at Nangal (punjab). Please Quote CST,VAT

For PUNJAB ALKALIES & CHEMICAL LIMITED

Please send your quotation in a sealed envelop mentioning our enquiry Ref.No. strictly on the top of the envelope.

KRISHAN KUMAR GOYAL
DY MANAGER (PROJECTS)

-
- 1.Quotation received after the due date may not be considered.
 - 2.Exact rates of Sales Tax, Central Sales Tax, Excise duty,Octroi etc. whenever leviable should be clearly specified by you in your quotation, as no subsequent claims will be entertained by us in respect of these, it will not be sufficient to applicable.
 - 3.Any alteration or erasure in the quotation should be absolutely legible & duly attested. Over-writing or over-typing of any information may disqualify your quotation.
 - 4.Our enquiry reference must be indicated clearly on top of the envelope.
 - 5.Your quotation must be for units specified in this enquiry and should be valid for 90 days from date of opening of offer.
 - 6.At our option we may change the quantity of our requirement, or delete items.
 - 7.Please give detailed specification and indicate the name of manufacturer of each item and enclose literature.
 - 8.Your offer should be duly supported by all relevent technical literature/catalogue/brochure etc.
 - 9.Please quote clearly whether your warehouse is covered under excise preview or not. We shall like you to supply material through cenvetable invoice. Next of



modvat notes will be compared for commercial evaluation.

IMP: PLEASE INDICATE TARRIF/SUB HEAD UNDER WHICH EXCISE DUTY IS TO BE CHARGED.

□

DIMENSIONAL DRAWING FOR INSTRUMENTS AIR DRYER CONTROL PANEL

Removable gland plate

-  32 mm hole
-  19 mm hole

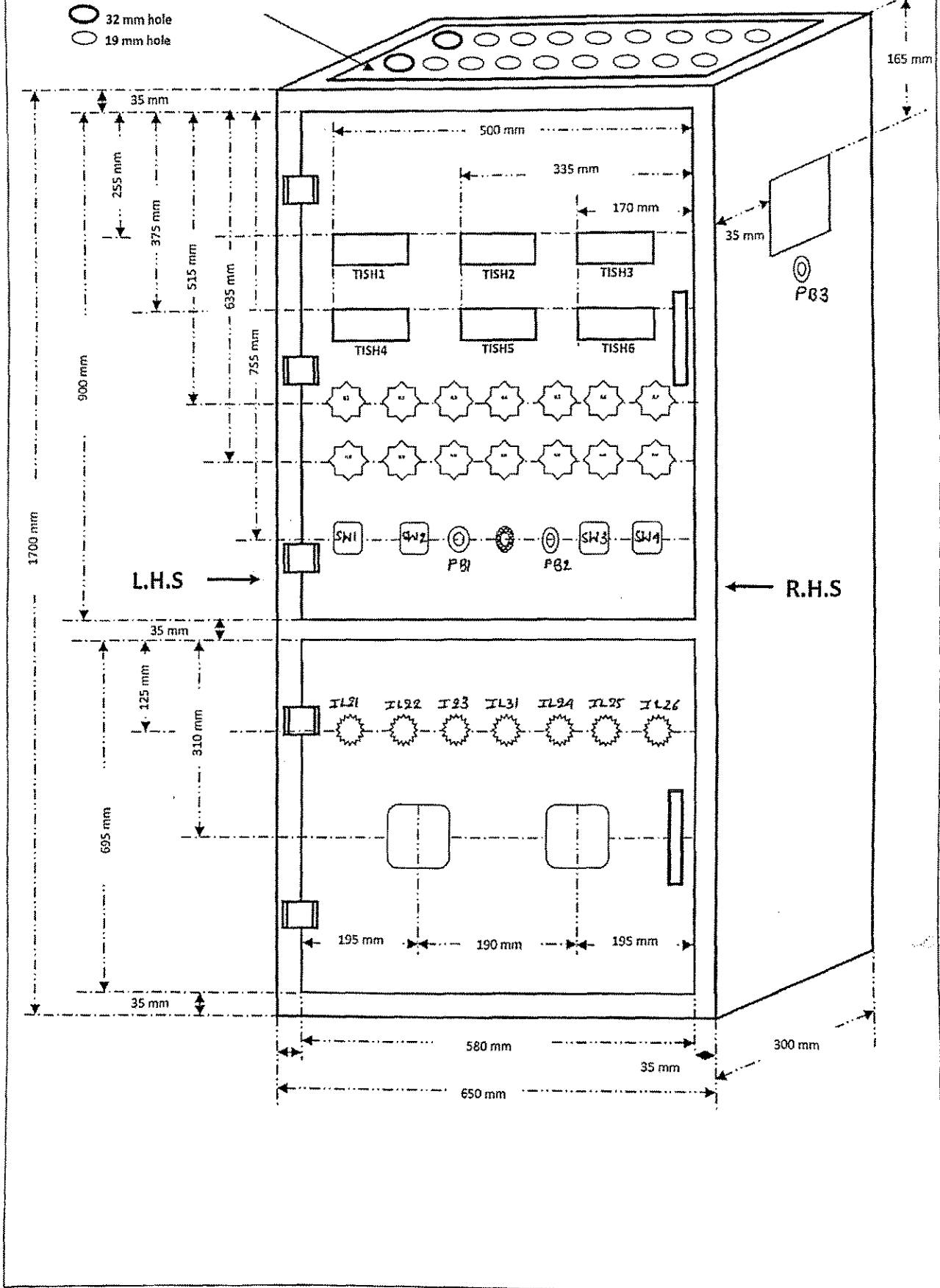

Indicative figures description and face tags

1. TICs(temperature indicator controllers)

Cut-out size 44(H) x 92(W) mm landscape style

Face tags are TISH1, TISH2, TISH3, TISH4, TISH5 and TISH6

2. Led indication lamps

Round shape (22.5 Ø) 110 VAC

Face tags are

<u>IL. No.</u>	<u>Tag print</u>	<u>IL no.</u>	<u>Tag print</u>
IL1	COMP. ON	IL8	CONTROL SUPPLY ON
IL2	REACT VALVE OPEN	IL9	AUTO
IL3	HOT AIR TEMP. HIGH	IL10	MANUAL
IL4	FAULT	IL11	A ON ADSORBTION
IL5	TOP BED TEMP. HIGH	IL12	B ON ADSORBTION
IL6	BOTTOM BED TEMP. HIGH	IL13	IDLING ON
IL7	FAULTY CHANGEOVER	IL14	HEATER ON

3. Selector switch

Double pole single throw with two ON marking on 9 & 3 'O' clock positions and two OFF marking on 12 & 6 clock positions.

Face tags are

<u>SW. NO</u>	<u>Tag print</u>	<u>SW. NO</u>	<u>Tag print</u>
SW1	CONTROL SUPPLY	SW3	REACT VALVE TO OPEN
SW2	AUTO/MANUAL	SW4	HEATER ON

4. Push buttons

Round shape (22.5 Ø) push buttons with flush style actuator and with replaceable elements, colours and face tags are as follows

<u>PB. NO</u>	<u>Tag print</u>	<u>Element</u>	<u>Actuator colour</u>
PB1	LAMP & HOOTER TEST	3*NO	GREEN
PB2	RESET	1*NO	Black
PB3	HOOTER SILENCE	1*NO	Blue

5. Push buttons with LED indication

Round shape (22.5 Ø) push buttons with flush style GREEN colour actuator and with replaceable NO type element.

Face tags should mention as "COL. CHANGEOVER"

6. Led indication lamps

Round shape (22.5 Ø) 220 VAC

Face tags are

<u>IL. No.</u>	<u>Tag print</u>	<u>IL no.</u>	<u>Tag print</u>
IL21	415 R Ph.	IL24	HEATER R Ph.
IL22	415 Y Ph.	IL25	HEATER Y Ph.
IL23	415 B Ph.	IL26	HEATER B Ph.
IL31	110 VAC ON(110 VAC LED lamp)		

Bill of materials for instrument air dryer control panel (for control circuitry only)

S.N	ITEM	SPECIFICATIONS/MAKE		QTY
1	Control panel	As per drawing		01 no.
2	PLC	Micrologix 1000 (1761-L32BWA),		01 no.
3	24VDC, 2.5 A PSU	Siemens, Omron DIN rail mounted, 24VDC, 2.5 amp		01 no.
4	TICs	Temperature indicating controller		06 no.
5	110VAC relays	OEN (37A-4-110-SL, coil 4430 Ω) with DIN rail mounted base and protection diode		08 no.
6	MCBs	Double pole 6 amp DIN rail mounted MCB		02 no.
7	PVC cable duct with cover	1: 30 mm width* 60 mm height		12 m.
		2: 60 mm width* 60 mm height		05 m.
8	DIN rails	1: Yellow chromated/zinc passivated perforated Top hat DIN rail		03 m.
		2: Yellow chromated/zinc passivated perforated G section DIN rail		01 m.
9	Multistrand cables	Ratnaflex flexible multistranded cable (IS694) or better.		300 m.
10	LED indication lamps	Indication lamp (complete) MAKE: TEKNIC Shape: round Size: 22.5 mm	OR Schneider make model: Harmony Harmony XB7 series. Specifications, colour & and quantity same as in previous.	14 nos.
11	LED indication lamps	Indication lamp (complete) MAKE: TEKNIC Shape: round Size: 22.5 mm	OR Schneider make model: Harmony Harmony XB7 series. Specifications, colour & and quantity same as in previous.	07 nos.
12	Selector switches	Double pole single throw with two ON marking on 9 & 3 'O' clock positions and two OFF marking on 12 & 6 clock positions.		04 nos.
13	Flush type push buttons	Momentary push button actuator Size dia: 22.5 mm, Type: Flush		03 nos.
14	NO elements	NO type element		06 nos.
15	Push button with LED indicator	Illuminated flush actuator spring return with led bulb.(metallic series)) Size: 22.5 mm		01 nos.
16	Terminal blocks	Make: Elmex		40 nos.
17	Fused terminal blocks	Make: Elmex		14 nos.
18	Terminal blocks	Make: Elmex		12 nos.
19	Hooter 110 VAC	Solid state panel mounted buzzer, Dimension: 96X96mm, Panel out size: 92X92mm, supply voltage:110 VAC.		01 no.
20	Miscellaneous panel accessories	Various type & sizes of vinyl insulated lugs (U type, pin type and ring type), transparent spiral sleeve, silk thread, cable ties, self locking PVC cable ferrule, terminal blocks marker, etc.		
21	Step down transformer	Single phase 415/110 VAC, 750 VA transformer.		01 no.

NOTE:

1. Installed PLC should have 20 nos. inputs & 12 nos. outputs.
2. Total inputs used: 18 nos. and total output used: 12 nos..
3. PLC program for above mentioned panel for Allen Bradley (Micrologix 1000, 1761-L32BWA) PLC shall be provided by M/S PACL.
4. Wiring and instruments installation scheme shall be discuss on site, PACL Naya Nangal.